

TITLE : FILTER GRILL INSTALLATION FOR 2024 SIGNATURE MODELS

Process Description: Filter Grill Covering Revised Date 19-Mar-24

Created by Sagar Surendran Approved by John Tumanguil

ID# Process name Method

Installation
Equipment
Requirements



Using the screw and washer, install the following behind the filter grill cover:

- (1) The L-shaped holder on both sides of the filter grill cover
- (2) The curved holder at the bottom of the the filter grill cover

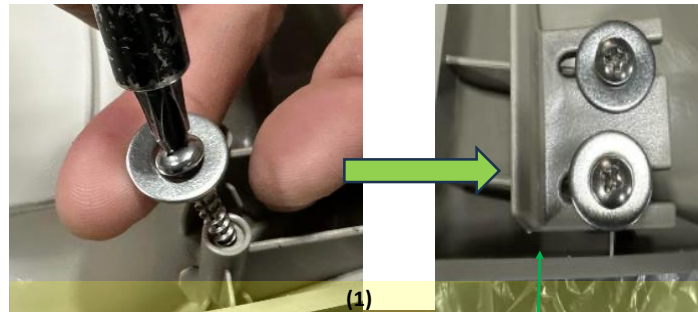

Both L-Shaped holders need to be installed using screws and washers.

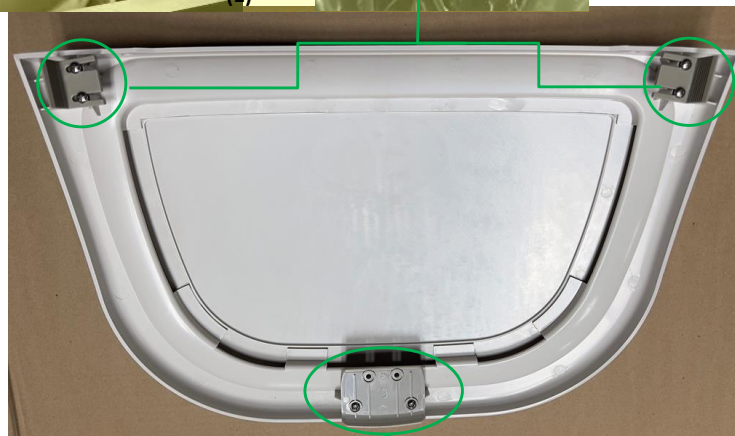

Step 1

Filter
Housing
Cover
Assembly

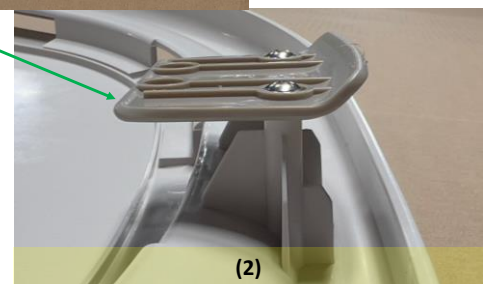

Ensure the orientation of the holder is correct : Curved edge outside.

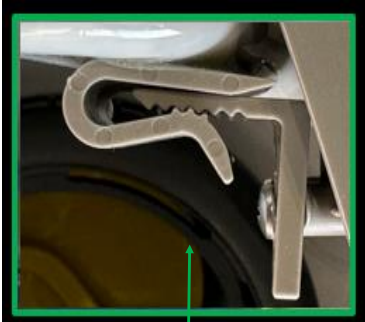
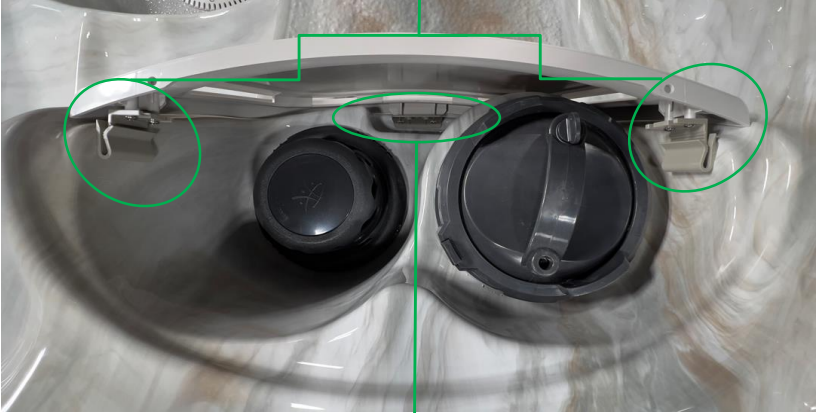

<p>Step 2</p>	<p>Installing Filter Housing Cover</p>	<p>Install the assembled filter grill cover on to the spa. Ensure all 3 clips of the front grill are properly secured into their respective locations</p>  <p>Clips on the filter grill can be adjusted left and right to fit into the clip on the spa if required</p>  
<p>Step 3</p>	<p>Installing Roof Cover</p>	<p>Roof Cover needs to be secured properly on the top. Locking pin underneath the roof cover must be pushed into the slots on the assembled grill cover.</p> 
<p>Step 4</p>	<p>Final Check</p>	<p>Cover the assembly with a protective wrap. Ensure there are no excessive gaps around the filter recess shroud.</p> 